

**LEGEND**

- SUBJECT SITE
- CONTOURS
- EXISTING BOUNDARIES
- EXISTING LOT NUMBERS
- PROPOSED BOUNDARIES
- PROPOSED LOT NUMBERS
- WATER
- POWER
- POWER POLE
- EXISTING BUILDINGS TO BE DEMOLISHED
- RECIPROCAL RIGHTS OF ACCESS EASEMENT
- EXISTING TREES TO BE RETAINED (IF POSSIBLE)
- EXISTING TREES TO BE REMOVED (AS PART OF DRIVEWAY CONSTRUCTION)
- EXISTING FEATURE STONE FENCE, VEHICLE AND PEDESTRIAN GATES TO BE RETAINED (WHERE POSSIBLE)
- INDICATIVE DRIVEWAY

**LOT SUMMARY**

ORIGINAL AREA (LOT 757)	1.5025ha
PROPOSED LOTS:	7
MINIMUM LOT AREA	2000m²
AVERAGE LOT AREA	2148m²
MAXIMUM LOT AREA	2367m²
TOTAL AREA	1.5025ha

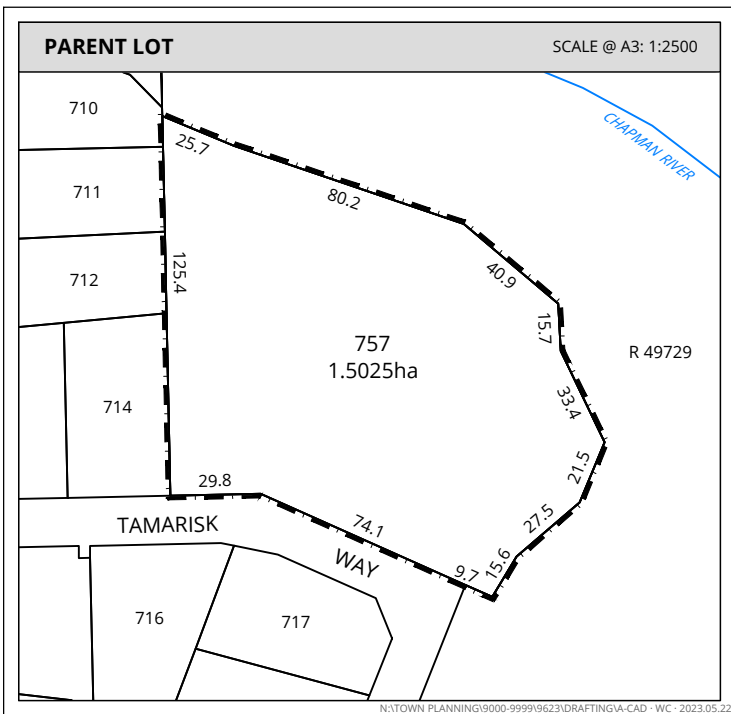

**PLAN OF SUBDIVISION**  
 LOT 757 (No. 22) TAMARISK WAY  
 WOORREE

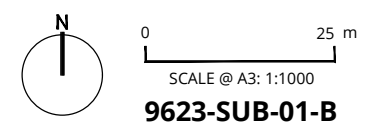

DRAWN: WC  
 DATE CREATED: 2023.05.22  
 PROJECTION: MGA50 GD94  
 CADASTRE: LANDGATE  
 CONTOURS: WATERCORP 2022  
 This document may not be reproduced without the written consent of Rowe Group. All areas and dimensions are subject to survey.







Map produced by the City of Greater Geraldton  
 W: [www.cgg.wa.gov.au](http://www.cgg.wa.gov.au) E: [council@cgg.wa.gov.au](mailto:council@cgg.wa.gov.au)

## Proposed Subdivision of Lot 757 Tamarisk Way, Woorree

Scale: 1:800

Date	23-May-23
Department	IS [Engineering - GIS]
Drawing No.	
Operator	RJT
Paper Size	A3

**Disclaimer:** Whilst all care has been taken in the preparation of this data, this information is provided as a guide only and no responsibility shall be taken for any omissions or errors in this documentation. The accuracy provided is not to be used for legal purposes, but reference made to original documentation, which includes Certificate of Titles, Survey Diagrams and legal versions of the Town Planning Schemes.