

LEGEND	
	SUBJECT SITE
	CONTOURS
	EXISTING BOUNDARIES
	EXISTING LOT NUMBERS
	PROPOSED BOUNDARIES
	PROPOSED LOT NUMBERS
	WATER
	POWER
	POWER POLE
	EXISTING BUILDINGS TO BE DEMOLISHED
	RECIPROCAL RIGHTS OF ACCESS EASEMENT

LOT SUMMARY	
ORIGINAL AREA (LOT 757)	1.5025ha
PROPOSED LOTS:	7
MINIMUM LOT AREA	2000m ²
AVERAGE LOT AREA	2148m ²
MAXIMUM LOT AREA	2367m ²
TOTAL AREA	1.5025ha

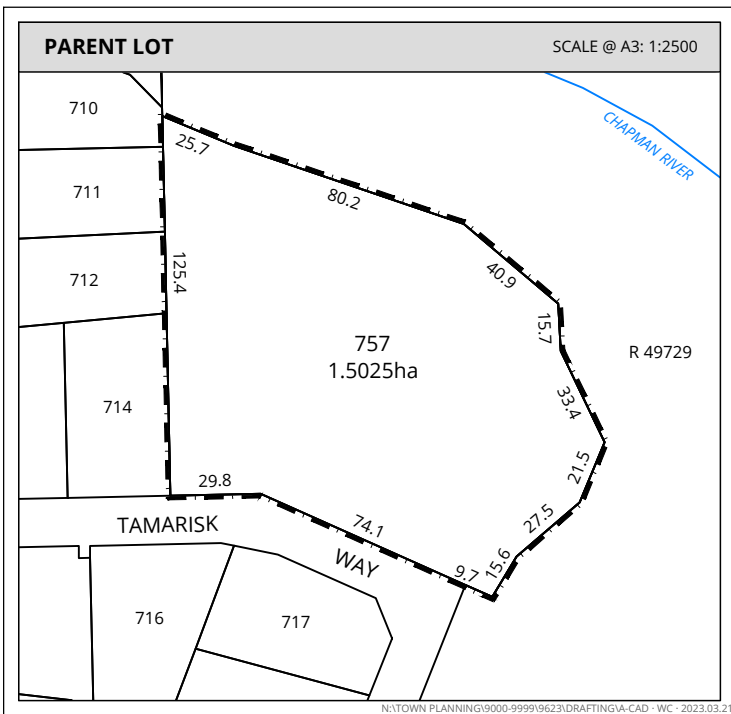

PLAN OF SUBDIVISION
 LOT 757 (No. 22) TAMARISK WAY
 WOORREE

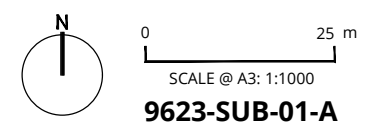

DRAWN: WC
 DATE CREATED: 2022.10.12
 PROJECTION: MGA50 GD94
 CADASTRE: LANDGATE
 CONTOURS: WATERCORP 2022

This document may not be reproduced without the written consent of Rowe Group. All areas and dimensions are subject to survey.



N:\TOWN PLANNING\9000-9999\9623\DRAWING\A-CAD - WC - 2023.03.21