

PROPOSED ROAD CLOSURE



Map produced by the City of Greater Geraldton
 W: www.cgg.wa.gov.au E: council@cgg.wa.gov.au

Aerial Plan

Scale: 1:1,500



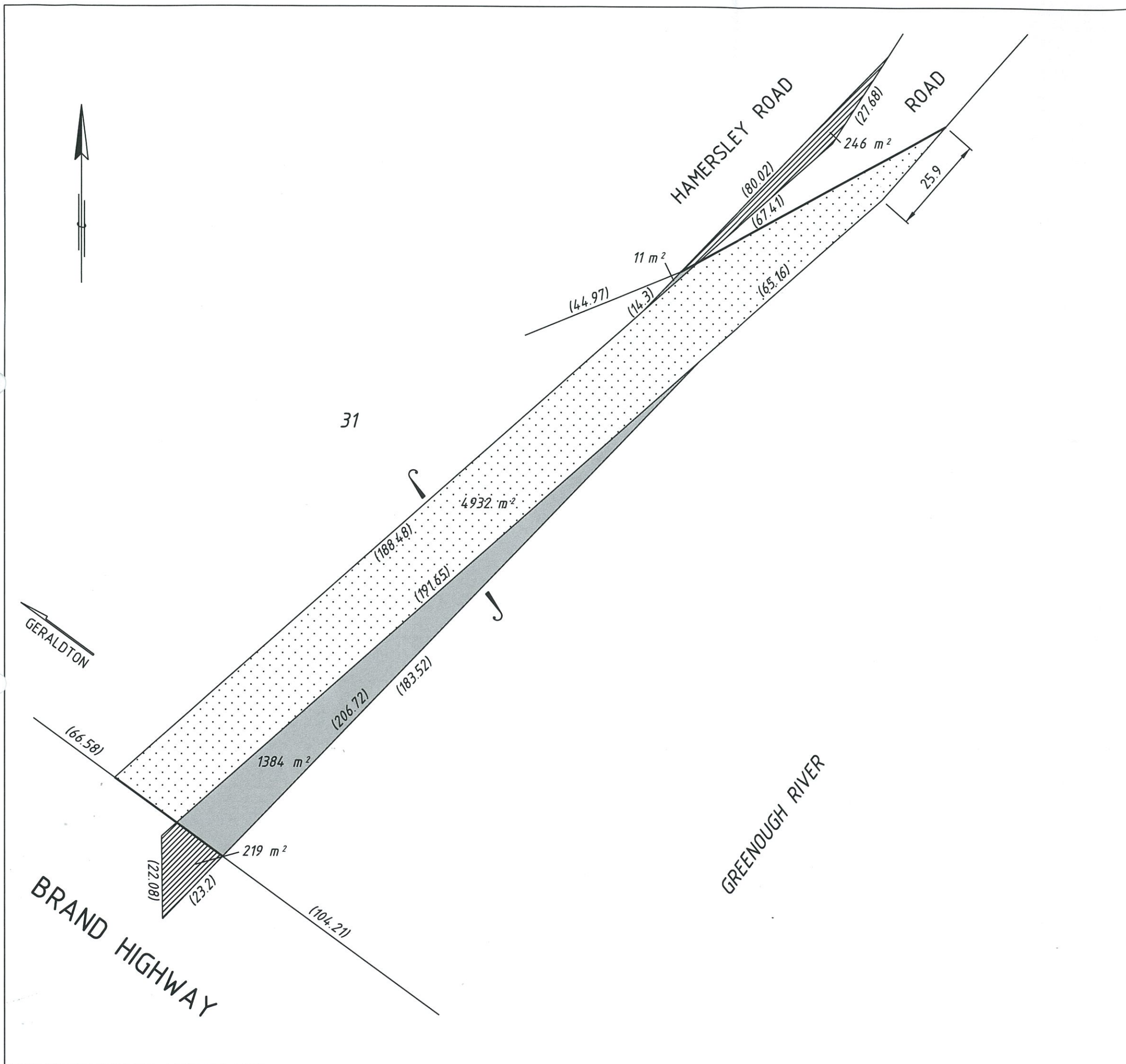

Date	05-Sep-16
Department	IS [Engineering - GIS]
Drawing No.	
Operator	RJT
Paper Size	A3

Disclaimer:

Whilst all care has been taken in the preparation of this data, this information is provided as a guide only and no responsibility shall be taken for any omissions or errors in this documentation. The accuracy provided is not to be used for legal purposes, but reference made to original documentation, which includes Certificate of Titles, Survey Diagrams and legal versions of the Town Planning Schemes.



LEGEND

-  LAND REQUIRED FOR ROAD PURPOSES
-  CLOSED ROAD TO BECOME RESERVE FOR FLOOD LEEVE
-  ROAD TO BE CLOSED & BECOME RESERVE FOR FLOOD LEEVE
-  BOUNDARY TO BE SURVEYED.

NOTES



- 1 DIMENSIONS AND AREAS ARE APPROXIMATE ONLY AND ARE SUBJECT TO SURVEY.
- 2 S.L.K. IS A M.R. STRAIGHT LINE KILOMETRE AND IS APPROXIMATE ONLY
- 3 HORIZONTAL DATUM IS MGA 94.
- 4 CADASTRAL MODEL: CAD1037A
- 5 REFER TO DRG 1160-177

PROPERTY MANAGEMENT

Telephone 9323 4580 Fax 9323 4600

APPROVED FOR IMPLEMENTATION

FILE NUMBER	FOLIO	DATE	APPROVAL NUMBER
15/4413			
AUTHORISED	Osima 30/7/2015		
APPROVED	R. S. Thorne 30/7/15		

FINANCE AND SERVICES
PROPERTY MANAGEMENT

Telephone 9323 4580 Fax 9323 4600

FILE No.	15/4413
DRAWN/DESIGNED	W.M. ROLLINGS 22/7/15
AUDITED IN ACCORDANCE WITH STANDARD 67-08-48 IN THE ROAD AND TRAFFIC ENGINEERING MANUAL	

BRAND HIGHWAY H4
LAND DEALINGS
ROAD & CLOSED ROAD, 342.1 SLK

LOCAL AUTHORITY (505) CITY OF GREATER GERALDTON

DRAWING TYPE	DRAWING NUMBER	AMEND.
7200	1560-060	

SCALE 1:1000
SCAN DATE
A
3