



180 Durlacher st /PO Box 892  
Geraldton 6530 WA  
Email: [gpi@geraldtonpersonnel.org.au](mailto:gpi@geraldtonpersonnel.org.au)

Ph. (08) 99643525  
Fax (08) 9964 3624

**26/02/2013**

**City of Greater Geraldton**  
Cathedral Avenue  
Geraldton WA 6530

Attention: Lyn Farrell  
**Finance Officer - Rates**

Dear Lyn

**RE: APPLICATION FOR RATES EXEMPTION**  
**Section 6.26 of the Local Government Act 1995**

Geraldton Personnel Inc. (GPI) is a Not for Profit Benevolent organisation that was established in 1989 to assist people with disabilities to gain and maintain award based employment of their choosing. Our core business is focused on providing training, support and assistance to any person with any disability to gain and retain employment.

Geraldton Personnel Inc. request that you view this letter as a written statement in support of the application form.

As part of our service we operate G-Force Contracting a self-funded operation of Geraldton Personnel. G-Force applies for projects in the Midwest region to provide employment opportunities for people with a disability, providing training in an open award based work environment to increase their opportunity in securing award based employment of their choosing. G-Force does not receive Government funding in order to exist. Any income derived from G-Force is then reinvested into the GPI service provision to support people with disabilities to gain and retain employment.

The property 180 Durlacher st Geraldton is used for the provision of support services to people with a disability who are seeking to gain and maintain employment within our local community. Activities on this premise are undertaken during regular business hours, Monday to Friday 8am to 4.30pm and include; pre-employment training, interview skills, resume writing, job preparation, social skills development.

These services are free of charge to people with disability.

Geraldton Personnel Inc. is seeking exemption from rates for 180 Durlacher st Geraldton, pursuant to the Local Government Act 1995. Section 6.26 (g) Land used exclusively for charitable purposes.

Please find attached the application form and attachments as required for consideration and please do not hesitate to contact me if you wish to discuss this further.

Yours sincerely

Chris Kerr  
Managing Director  
Geraldton Personnel Inc.



WESTERN AUSTRALIA

OATHS, AFFIDAVITS AND STATUTORY DECLARATIONS ACT 2005

STATUTORY DECLARATION

I, Tony Cooper - Executive Officer  
180 Durlacher St - Geraldton.  
(name, address and occupation of person making declaration)

sincerely declare as follows:-

Geraldton Personnel Inc. (GPI) is a Not for Profit Benevolent organisation that was established in 1989 to assist people with disabilities to gain and maintain award based employment of their choosing. Our core business is focused on providing training, support and assistance to any person with any disability to gain and retain employment.

The property 180 Durlacher st Geraldton is being leased out to ARAFMI (mental health carers) and also are a not for profit association. The premises include a purpose built wheelchair accessible training centre, and a refurbished house converted into office and meeting rooms. These services are free of charge to people with disability.

As part of our service we operate G-Force Contracting a self-funded operation of Geraldton Personnel. G-Force applies for projects in the Midwest region to provide employment opportunities for people with a disability, providing training in an open award based work environment to increase their opportunity in securing award based employment of their choosing. G-Force does not receive Government funding in order to exist. Any income derived from G-Force is then reinvested into the GPI service provision to support people with disabilities to gain and retain employment. There is an office and a shed for G-Force at the rear of 180 Durlacher st, which is used to manage the business, and house equipment for the gardening cleaning contract work undertaken off premises, including trailer and vehicles, mowers, edger's, etc.

Geraldton Personnel Inc. is seeking exemption from rates for 180 Durlacher st Geraldton, pursuant to the Local Government Act 1995. Section 6.26 (g) Land used exclusively for charitable purposes.

This declaration is true and I know that it is an offence to make a declaration knowing that it is false in a material particular.

This declaration is made under the *Oaths, Affidavits and Statutory Declarations Act 2005*

at 40 TERSOLA WAY, STRATHALBYN  
(place)

on 13th November 2013  
(date)

in the presence of -

[Signature]  
(Signature of authorised witness)

JENELLANN TAYLOR  
NURSE /  
REGISTERED MIDWIFE  
(Name of authorised witness and qualification as such a witness)

by [Signature]  
(Signature of person making the declaration)

**MARK DEMARTINI**  
**DESIGN & DRAFTING**  
 36 S CHARLWAN RD  
 GERALDTON, WA 6530  
 PH: (08) 95 550 050  
 FX: (08) 95 251 133  
 Email: design@vsn.com.au

**Proposed Offices**  
 CLIENT: GERALDTON PERSONNEL INC  
 ADDRESS: LOT 13 DURLACHER & SHENTON ST

OWNER: \_\_\_\_\_  
 WITNESS: \_\_\_\_\_  
 OWNER: \_\_\_\_\_  
 WITNESS: \_\_\_\_\_  
 BUILDER: \_\_\_\_\_  
 DATED: \_\_\_\_\_

**GENERAL NOTES:**  
 \* DIMENSIONS SHOULD NOT BE SCALED  
 \* BUILDERS/CONTRACTORS TO CONFIRM ALL DIMENSIONS ON SITE  
 \* ALL MATERIALS & CONSTRUCTION TO COMPLY WITH LOCAL COUNCIL REGULATIONS, PERTINENT AUSTRALIAN STANDARDS, THE CURRENT BUILDING CODE OF AUSTRALIA & ENGINEERS DRAWINGS SPECIFICATIONS

REV #	DATE	DRN
06-09-2007		MSE
10-03-07		
22-11-07		

JOB NO: 415-09-07  
 SHEET NO: \_\_\_\_\_  
 COPYRIGHT ©

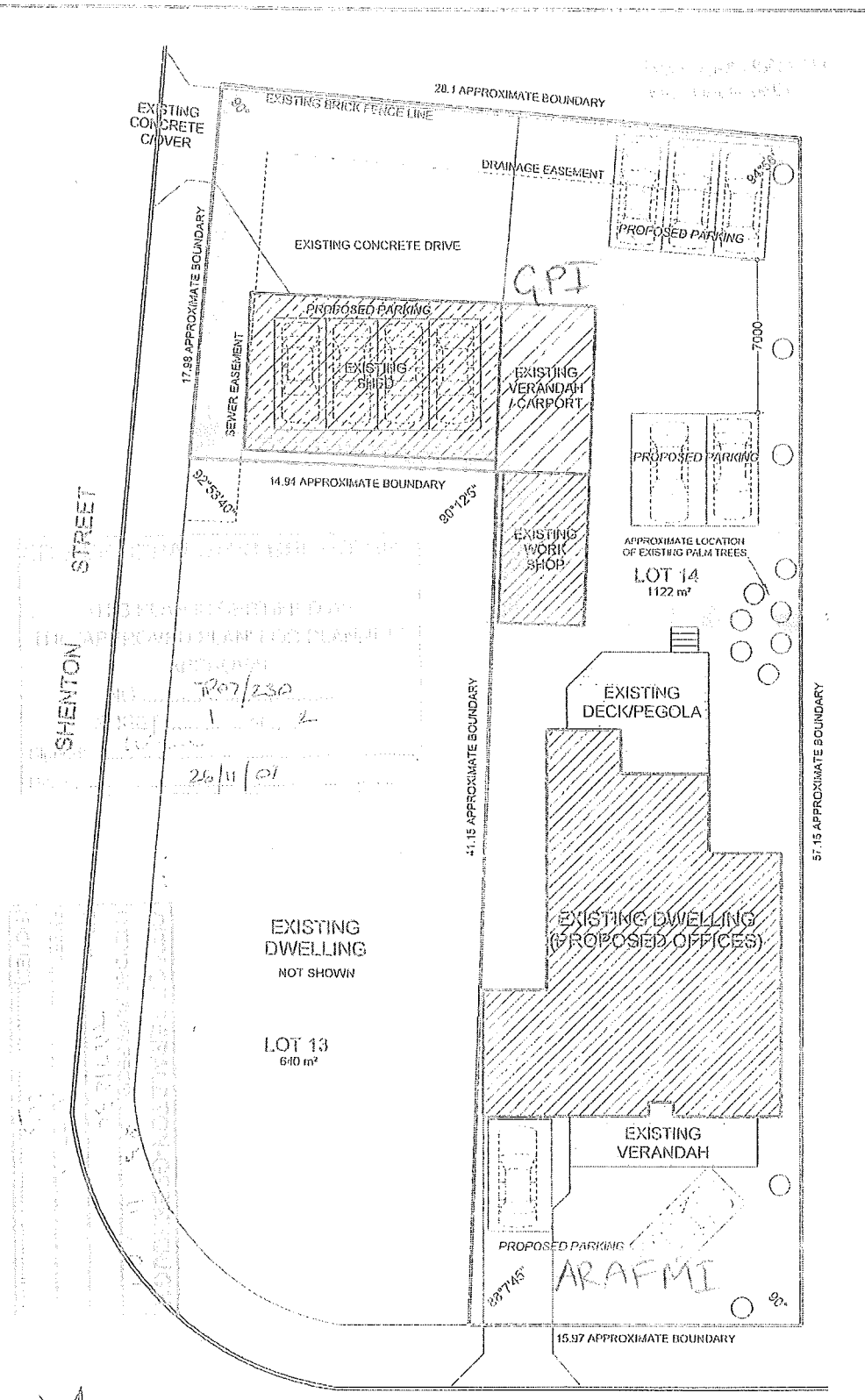

**SITE PLAN**  
 SCALE 1:500

**NOTE:**  
 \* THIS SITE PLAN IS DIAGRAMATIC ONLY!  
 IF COMPROMISED BOUNDARY LOCATIONS / PEGS OR LEVELS ARE REQUIRED, IT IS THE RESPONSIBILITY OF THE OWNER TO CONTRACT A QUALIFIED LICENSED SURVEYOR