

Attachment - IS327 Flores Road / Eastward Road Roundabout Layout

Plant Schedule	Symbol	Botanical Name	Common Name	Height (M)	Spread (M)	Spacing (M2)	Pot Size	Quantity	Symbol	Botanical Name	Common Name	Height (M)	Spread (M)	Spacing (M2)	Pot Size	Quantity
TREES																
Cca	18 Aci	<i>Corymbia calophylla</i>	Mani	15	12	45L	18	18	Agr	<i>Acacia gregori prostrata</i>	Acacia gregori prostrata	0.6	2	0.5	Tubestock	209
Cki	18 Aca	<i>Callistemon Kings Park Special</i>	Bottlebrush	4	4	45L	11	11	Asa	<i>Acacia saligna prostrata 'Springtime cascade'</i>	Acacia 'springtime cascade'	0.2	2	0.5	Tubestock	209
Ego	18 Euc	<i>Eucalyptus gomphocephala</i>	Tuart	30	15	45L	14	14	Cem	<i>Calandrinia 'Emerald Carpet'</i>	One Sided Bottlebrush 'Emerald Carpet'	0.2	0.8	0.5	Tubestock	209
Eto	18 Dre	<i>Eucalyptus torquata</i>	Coral Gum	10	7	45L	8	8	Dre	<i>Dianella revata 'Little Ray'</i>	Dianella 'Little Ray'	0.5	0.5	0.5	Tubestock	209
Evi	18 Egl	<i>Eucalyptus vitix 'Snow Queen'</i>	Powderbark Coolabah	8	6	45L	15	15	Egl	<i>Eremophila glabra 'Kalbarri Carpet'</i>	Tar Bush	0.2	2	0.5	Tubestock	209
LARGE SHRUBS																
Gci	3 Grc	<i>Grevillea 'City Lights'</i>	Grevillea	3	3.5	30L	8	8	Lbr	<i>Leucophyta brownii 'Silver Nugget'</i>	Cushion Bush 'Silver Nugget'	0.5	0.5	0.5	Tubestock	209
Ggo	3 Grc	<i>Grevillea 'Golden Lyre'</i>	Grevillea	2.5	3.5	30L	12	12	Mhu	<i>Melaleuca 'tagalii' 'Rambler'</i>	Chenille honey myrtle 'Rambler'	0.2	2	0.5	Tubestock	209
SHRUBS (1 PLANT / 2 SQM)																
Bas	2 Bas	<i>Banksia ashbyi 'Dwarf'</i>	Banksia ashbyi 'Dwarf'	2	1.5	0.5	Tubestock	283	Bni	<i>Banksia nivea</i>	Honeypot Dryandra	1	1	0.5	Tubestock	283
Cqu	2 Cqu	<i>Calothamnus quadrifidus subsp. homalophyllus</i>	Murchison Clawflower	2	1.5	0.5	Tubestock	283	Csa	<i>Calothamnus sanguineus</i>	Silky-leaved blood flower	1	1.5	0.5	Tubestock	283
Dgr	2 Dgr	<i>Diplopoma grandiflora</i>	Murchison Rose	1.5	1	0.5	Tubestock	283	Dre	<i>Dianella revata</i>	Blueberry Lily	1.5	0.8	0.5	Tubestock	283
Gor	2 Gor	<i>Grevillea crotinifolia</i>	Grevillea crotinifolia	0.8	1.5	0.5	Tubestock	283	Gtr	<i>Grevillea triloba</i>	Grevillea triloba	1.2	2	0.5	Tubestock	283
Mbi	2 Mbi	<i>Mananthus bicolor</i>	Painted Mananthus	1	2	0.5	Tubestock	283	Msy	<i>Melaleuca systena</i>	Coastal Honeymyrtle	1.5	2	0.5	Tubestock	283
BASIN EMBANKMENT (1 PLANT / 2 SQM)																
Bsp	1.2 Bsp	<i>Bossiaea spinescens</i>	Bossiaea	1.2	1.2	0.5	Tubestock	96	Cch	<i>Conostylis canadensis</i>	Grey Cottonhead	0.4	0.5	0.5	Tubestock	96
Cpl	0.2 Cpl	<i>Carpobrotus virescens</i>	Coastal Pigface	0.2	3	0.5	Tubestock	96	Cco	<i>Chorizanthe cordatum</i>	Hear-Leafed Flame Pea	1	1.2	0.5	Tubestock	96
Etm	0.6 Etm	<i>Enchlyaena tomentosa</i>	Ruby Saltbush	0.6	2	0.5	Tubestock	96	Mra	<i>Melaleuca radula</i>	Graceful Honeymyrtle	2	1.5	0.5	Tubestock	96
Tba	1.2 Tba	<i>Thyptidomene banksiaeacea</i>	Myrtle	1.2	2	0.5	Tubestock	96	Wda	<i>Westringia dampieri</i>	Coastal Rosemary	1.2	1.5	0.5	Tubestock	96
BASIN BOTTOM (1 PLANT / 2 SQM)																
Cac	0.5 Cac	<i>Conostylis aculeata</i>	Cottonhead	0.5	0.6	0.5	Tubestock	34	Fno	<i>Ficinia nodosa</i>	Knobby Club Rush	1	1	0.5	Tubestock	34
Hpu	0.3 Hpu	<i>Hemiantra pungens</i>	Snake Vine	0.3	3	0.5	Tubestock	34	Kpr	<i>Kennedia prostrata</i>	Scarlet Runner	0.1	4	0.5	Tubestock	34
Mn	0.3 Mn	<i>Melaleuca incana 'Prostrate'</i>	Melaleuca incana 'Prostrate'	0.3	3	0.5	Tubestock	34								

NOTES:
ALL DRAWINGS TO BE READ IN COLOUR.
ALL COMPLETED WORKS TO BE PROTECTED AND MAKE GOOD ANY DAMAGE TO EXISTING WORKS CAUSED AS PART OF THIS CONTRACT. ALL WORK WITHIN DRIP LINES OF EXISTING TREES IS TO BE DONE BY HAND.
ALL SET OUT IS TO BE DONE BY A LICENSED SURVIVOR. THESE DRAWINGS WILL BE MADE AVAILABLE DIGITALLY TO THE SURVIVOR UPON REQUEST.
FIGURED DIMENSIONS SHALL TAKE PRECEDENCE OVER SCALED DIMENSIONS. SHEETS AND DETAIL DRAWINGS TAKE PRECEDENCE & NOTIFY SUPERINTENDENT OF ANY IDENTIFIED DISCREPANCIES PRIOR TO UNDERGOING WORK.
WHERE MOVED PLANTING IS PROPOSED PLANT IN GROUPS OF 3, 5 OR 7 OF THE SAME SPECIES.

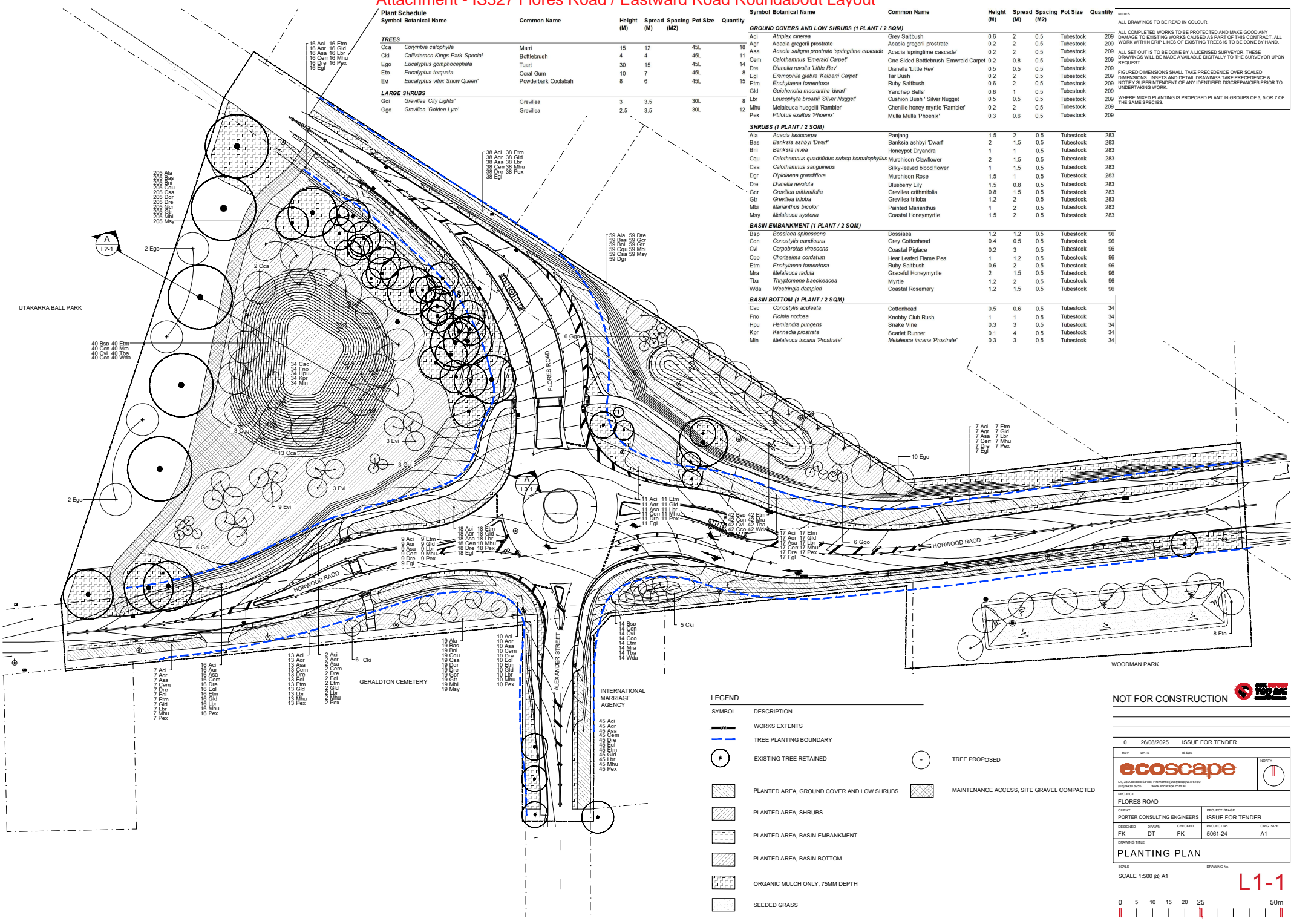

LEGEND

SYMBOL	DESCRIPTION
(Solid black line)	WORKS EXTENTS
(Dashed blue line)	TREE PLANTING BOUNDARY
(Circle with dot)	EXISTING TREE RETAINED
(Circle with cross)	TREE PROPOSED
(Hatched pattern)	PLANTED AREA, GROUND COVER AND LOW SHRUBS
(Hatched pattern)	PLANTED AREA, SHRUBS
(Hatched pattern)	PLANTED AREA, BASIN EMBANKMENT
(Hatched pattern)	PLANTED AREA, BASIN BOTTOM
(Hatched pattern)	ORGANIC MULCH ONLY, 75MM DEPTH
(Hatched pattern)	SEEDED GRASS
(Hatched pattern)	MAINTENANCE ACCESS, SITE GRAVEL COMPACTED

NOT FOR CONSTRUCTION

0 26/08/2025 ISSUE FOR TENDER

REV	DATE	ISSUE
0	26/08/2025	ISSUE FOR TENDER

ecoscape

L1, 38 Adelaide Street, Fremantle (Woodsbag) WA 6150
(08) 9433 8933 www.ecoscape.com.au

FLORES ROAD

CLIENT	PROJECT STAGE
PORTER CONSULTING ENGINEERS	ISSUE FOR TENDER

DESIGNED	DRAWN	CHECKED	PROJECT No.	ORIG. SIZE
FK	DT	FK	5061-24	A1

DRAWING TITLE: **PLANTING PLAN**

SCALE: 1:500 @ A1

9 5 10 15 20 25 50m

L1-1