

**LEGEND**

- City of Greater Geraldton lots to be dedicated as George Road/Henry Street
- Roman Catholic Church lot to be dedicated as George Road

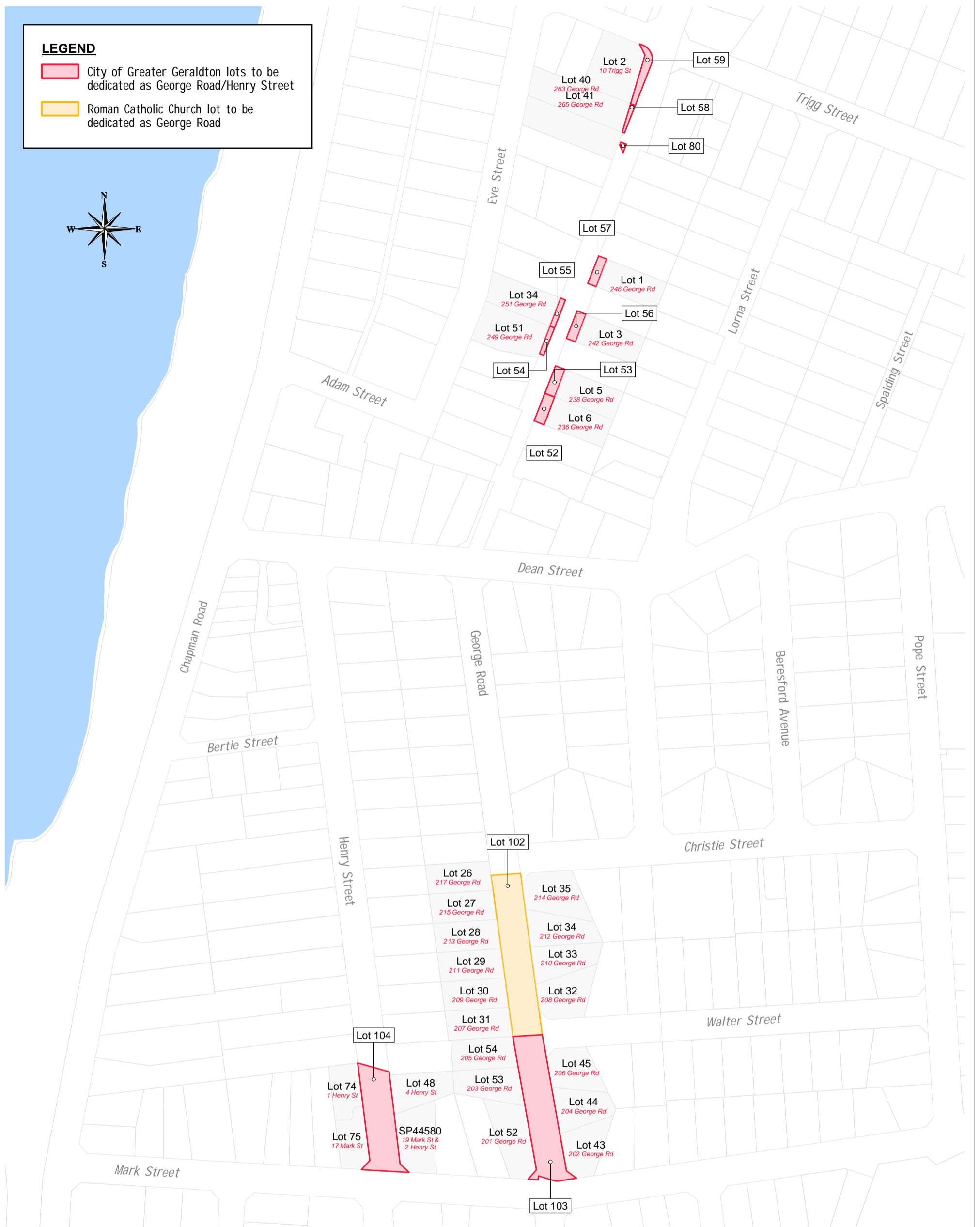

**Disclaimer:** Whilst all care has been taken in the preparation of this data, this information is provided as a guide only and no responsibility shall be taken for any omissions or errors in this documentation. The accuracy provided is not to be used for legal purposes, but reference made to original documentation, which includes Certificate of Titles, Survey Diagrams and legal versions of the Town Planning Schemes.

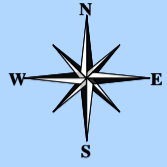

**Dedication of Portion of George Rd & Henry St**

Scale: 1:2,500

Map produced by the City of Greater Geraldton  
 W: www.cgg.wa.gov.au E: council@cgg.wa.gov.au

Date	25-May-18
Department	IS [Engineering - GIS]
Drawing No.	RC113
Operator	RJT
Paper Size	A3



**LEGEND**

 City of Greater Geraldton lots to be dedicated as George Road

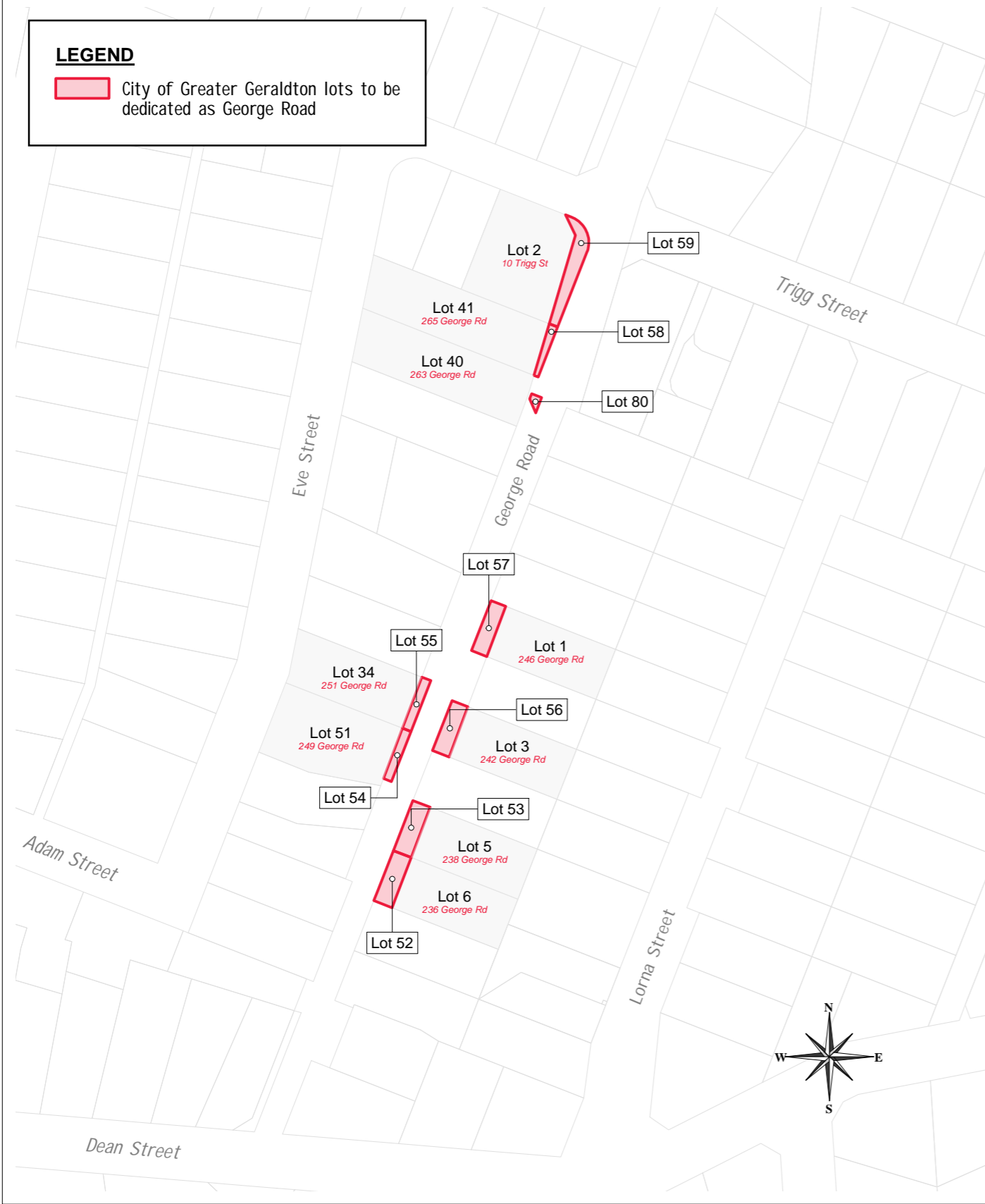

Map produced by the City of Greater Geraldton  
W: [www.cgg.wa.gov.au](http://www.cgg.wa.gov.au) E: [council@cgg.wa.gov.au](mailto:council@cgg.wa.gov.au)

## Dedication of Portion of George Road, Beresford

Scale: 1:2,000

Date	25-May-18
Department	IS [Engineering - GIS]
Drawing No.	RC113
Operator	RJT
Paper Size	A3

**Disclaimer:** Whilst all care has been taken in the preparation of this data, this information is provided as a guide only and no responsibility shall be taken for any omissions or errors in this documentation. The accuracy provided is not to be used for legal purposes, but reference made to original documentation, which includes Certificate of Titles, Survey Diagrams and legal versions of the Town Planning Schemes.



**LEGEND**

- City of Greater Geraldton lots to be dedicated as George Road/Henry Street
- Roman Catholic Church lot to be dedicated as George Road

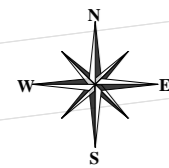

Map produced by the City of Greater Geraldton  
 W: [www.cgg.wa.gov.au](http://www.cgg.wa.gov.au) E: [council@cgg.wa.gov.au](mailto:council@cgg.wa.gov.au)

## Dedication of Portion of George Road & Henry Street, Beresford

Scale: 1:2,000

Date	25-May-18
Department	IS [Engineering - GIS]
Drawing No.	RC113
Operator	RJT
Paper Size	A3

**Disclaimer:** Whilst all care has been taken in the preparation of this data, this information is provided as a guide only and no responsibility shall be taken for any omissions or errors in this documentation. The accuracy provided is not to be used for legal purposes, but reference made to original documentation, which includes Certificate of Titles, Survey Diagrams and legal versions of the Town Planning Schemes.