

FITZGERALD STREET



LOCALITY PLAN

SK-3	Issue for CLIENT COMMENT	11/05/21
SK-2	Issue for CLIENT COMMENT	18/05/21
SK-1	Issue for CLIENT COMMENT	14/05/21
REVISION		DATE
TEAKLE & LALOR <i>building design and drafting consultants</i>		
Address: 61/219 Foreshore Drive, Geraldton. Phone: (08) 9964 1882 Email: t@teakleandlalo.com.au Website: www.teakleandlalo.com		
PROPOSED ALTERATIONS AT LOT 218 FITZGERALD STREET, GERALDTON		
CLIENT BATAVIA BREWERY		
DRAWING TITLE SITE PLAN		
SCALE # A2	1:200	DRAWN BY KHF
DATE	14/05/2021	DRAWING No. REV.
JOB No.	21034	1 OF 2 SK-3

AREAS:
EXISTING BUILDING 750m²

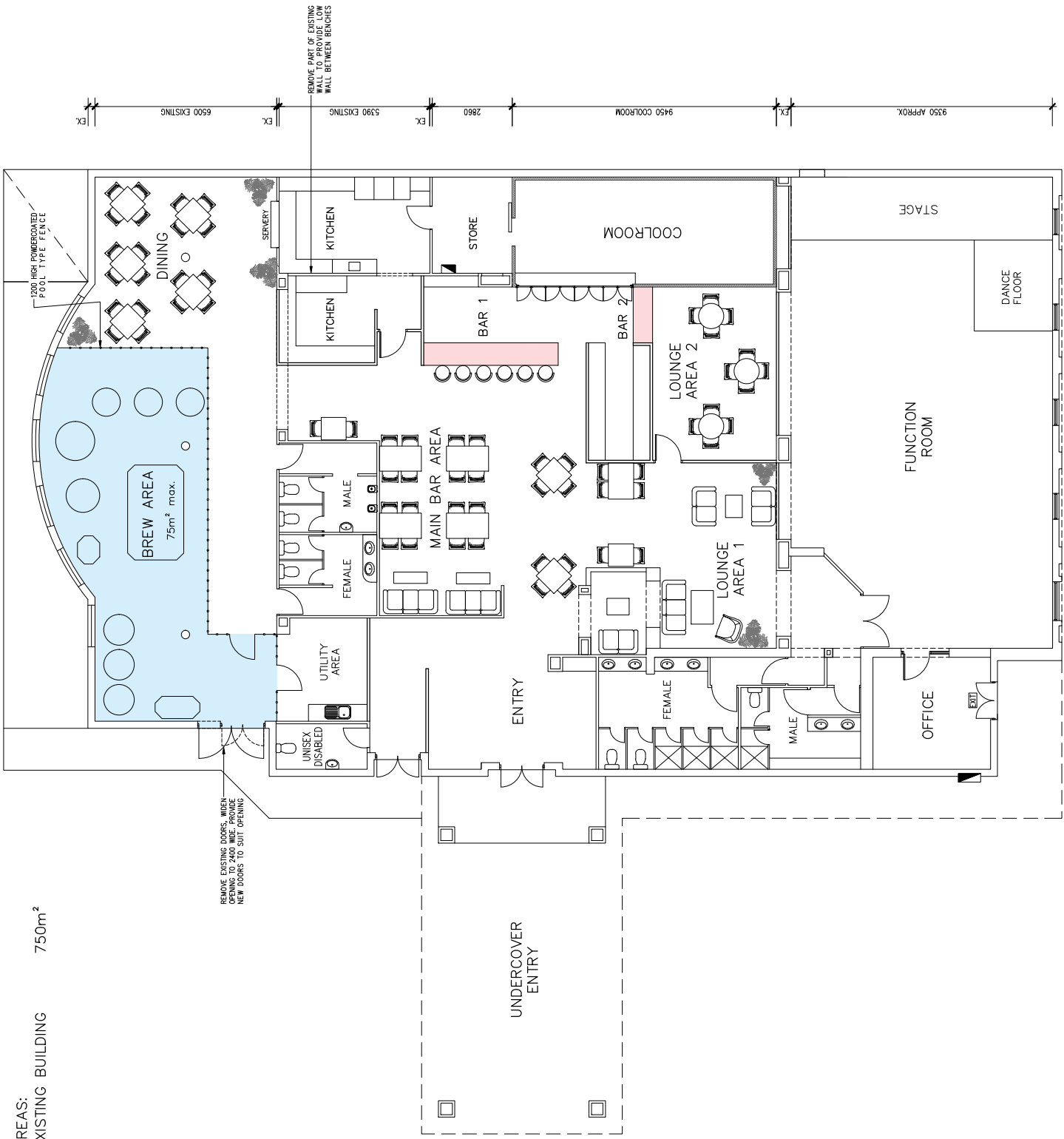

SK-3	Issue for CLIENT COMMENT	11/08/21
SK-2	Issue for CLIENT COMMENT	18/05/21
SK-1	Issue for CLIENT COMMENT	14/05/21
REVISION	DATE	
TEAKLE & LALOR <i>building design and drafting consultants</i> Address: 61/219 Foreshore Drive, Geraldton. Phone: (08) 9964 1882 Email: t@teakleandlalar.com.au Website: www.teakleandlalar.com		
PROPOSED ALTERATIONS AT LOT 218 FITZGERALD STREET, GERALDTON		
CLIENT BATAVIA BREWERY		
DRAWING TITLE FLOOR PLAN		
SCALE @ A2	DRAWN BY	KHF
1:100		
DATE	DRAWING No.	REV.
14/05/2021		
JOB No.		2 OF 2
21034		SK-3