

20 November 2025

Waste Management Plan

Community Facility at No.30 Ainsworth Street, Geraldton

This Waste Management Plan ('WMP') has been prepared in support of an Application for Development Approval for the construction of a community facility on the land situated at No.30 Ainsworth Street, Geraldton ('site').

The development comprises ten (10) Crisis Accommodation units for people affected by family, domestic and sexual violence, including two (2) one-bedroom units, six (6) two-bedroom units and two (2) three-bedroom units. An Administration Building with a floor area of 250m² is also proposed.

The WMP sets out the anticipated waste generation levels, bin storage requirements and waste collection approach for the proposed development, once operational. The WMP does not consider waste management during construction, which may need to be addressed at the Building Permit stage.

Subject to any relevant conditions of Development Approval, waste collection and disposal is to be undertaken in accordance with this WMP.

Waste Generation Rates

The City of Greater Geraldton ('City') requires the estimated waste generation rates for the development to be calculated in accordance with guidance published by the Western Australian Local Government Association ('WALGA'). The following relevant waste generation rates could be applied to the proposed development.

WALGA Publication & Land Use	General Waste Generation Rates	Recycling Waste Generation Rates
Commercial and Industrial Waste Management Guidelines		
Backpacker Accommodation	40 litres / occupant / week	20 litres / occupant / week
Boarding House	60 litres / occupant / week	20 litres / occupant / week
Offices	10 litres / 100m ² / day	10 litres / 100m ² / day
Multiple Dwelling Waste Management Plan Guidelines		
One-Bedroom Dwelling	80 litres / dwelling / week	40 litres / dwelling / fortnight
Two-Bedroom Dwelling	160 litres / dwelling / week	80 litres / dwelling / fortnight
Three-Bedroom Dwelling	240 litres / dwelling / week	240 litres / dwelling / fortnight

The following WALGA waste generation rates have been used for the purpose of estimating the amount of waste likely to be generated by the proposed development. For the Administration Building, while the number of staff present on weekends will be limited, for the purpose of this WMP, the applicable waste generation rate has been applied seven (7) days per week.

WALGA Publication & Land Use	General Waste Generation Rates	Recycling Waste Generation Rates
Commercial and Industrial Waste Management Guidelines		
Administration Building (250m ²)	10 litres / 100m ² / day (7)	10 litres / 100m ² / day (7)
Multiple Dwelling Waste Management Plan Guidelines		
One-Bedroom Units (2)	80 litres / dwelling / week	40 litres / dwelling / fortnight
Two-Bedroom Units (6)	160 litres / dwelling / week	80 litres / dwelling / fortnight
Three-Bedroom Dwelling (2)	240 litres / dwelling / week	240 litres / dwelling / fortnight

The above rates are considered to accurately reflect the amount of waste expected to be generated by the proposed development, as shown below.

Land Use	Estimated Waste Generation by Waste Stream	
	General Waste	Recycling Waste
Administration Building (250m ²)	175 litres / week	350 litres / fortnight
One-Bedroom Units (2)	160 litres / week	80 litres / fortnight
Two-Bedroom Units (6)	960 litres / week	480 litres / fortnight
Three-Bedroom Units (2)	480 litres / week	480 litres / fortnight
Total	1,775 litres / week	1,390 litres / fortnight

Waste Collection

A review of the City's website indicates the City provides a weekly General Waste service to residential and commercial premises, utilising 240 litre bins.

The City does not offer a Recycling or Food Organics and Garden Organics ('FOGO') waste collection service, with residents encouraged to drop-off recyclable materials and FOGO at various locations around the City.

For the purpose of estimating the number of bins required by the development, this WMP assumes that all waste generated by the development will be collected utilising the City's weekly General Waste service. This means the estimated 1,390 litres / fortnight of recycling waste is equivalent to an additional 695 litres of general waste / week.

The table below shows the number of bins required to meet the waste generation needs of the development.

Item	Estimated Waste Generation by Waste Stream	
	General Waste	Recycling Waste
Collection Frequency	Weekly	Estimated 1,390 litres of Recycling Waste / fortnight (695 litres / week) included in General Waste stream (i.e. 1,775 + 695 = 2,470 litres).
Waste per Week	2,470 litres	
Waste per Fortnight	-	
Number of Bins Required	11 x 240 litre bins	
Capacity of Bins Required	2,640 litres	
Number of Bins Proposed	16 x 240 litre bins	
Capacity of Bins Required	3,940 litres	

Bin Store

The Development Application proposes a communal Bin Store of 16m² at the eastern end of the car park.

A total of 16 bins can be accommodated in the Bin Store, which is more than adequate to meet the estimate waste that will be generated by the development. Given the Bin Store has capacity for more bins than required, it is anticipated the Bin Store will have space for temporary storage of bulk waste.

The Bin Store is provided with a pedestrian access gate from the internal footpath. The Bin Store will also be fitted with a tap and floor waste and all finished surfaces will be impervious.

Bin Collection

It is intended that waste be collected by the City from the verge of Ainsworth Street.

There is sufficient room on the verge to provide bin pads for placement of bins as per the collection schedule (i.e. weekly General Waste collection).

The caretaker for the development will be responsible for placing bins on the verge ready for collection. Bins will be placed either in the evening before the day of collection, or early morning on the day of collection. The caretaker will return bins to the Bin Store after collection.

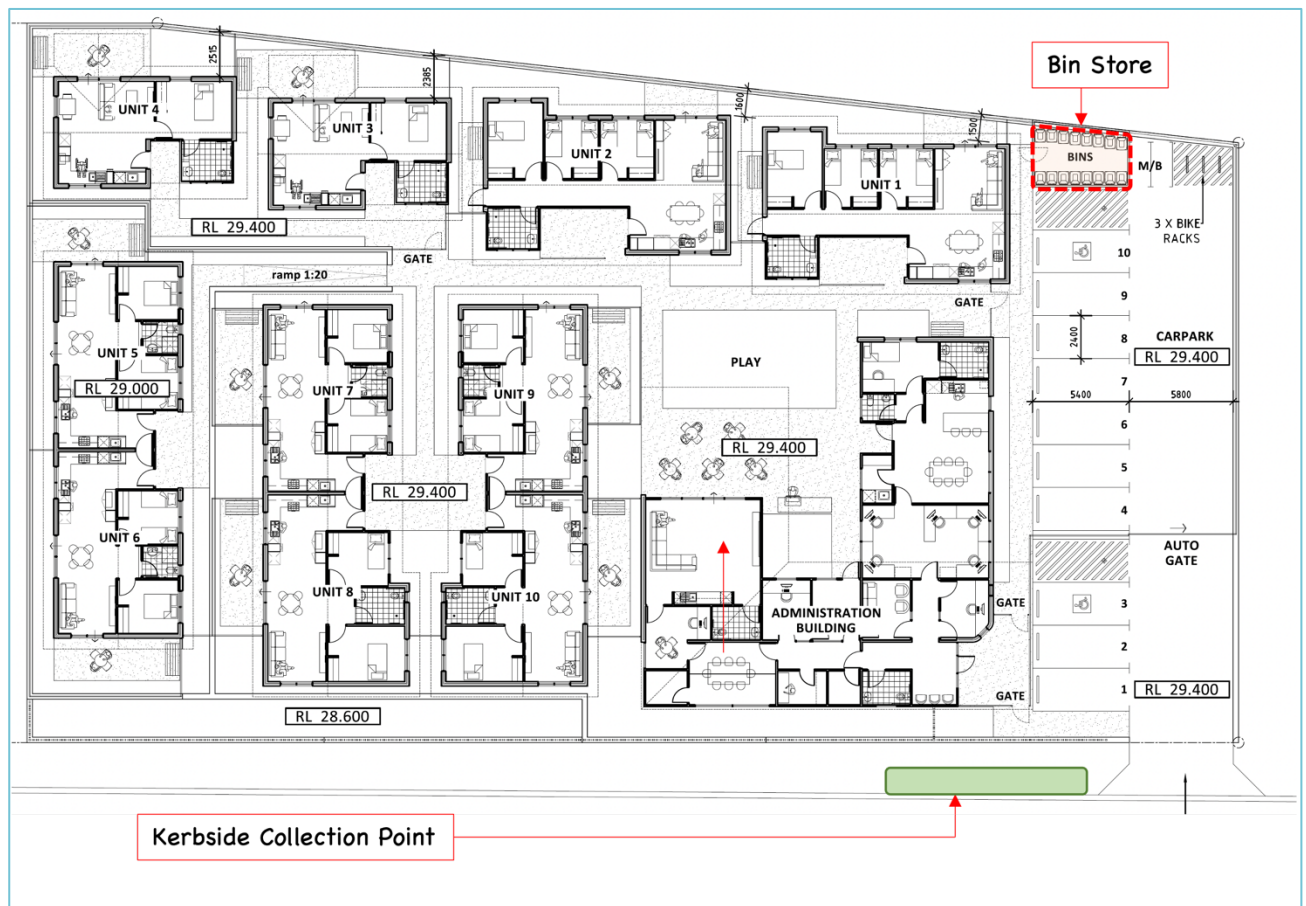

Figure 1: Bin Stores and Verge Collection Point